

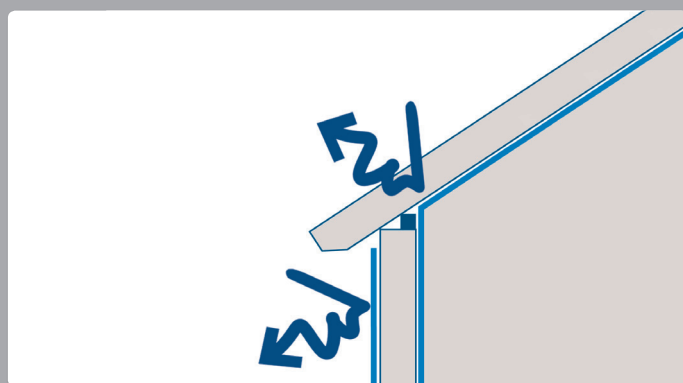

EDIL-Therm[®]



EXTERNAL THERMAL
INSULATION SYSTEM

EDIL-Therm[®] SYSTEM

EDIL-Therm[®] is a system of exterior thermal insulation. It is composed of expanded polystyrene thermal insulating boards (EPS). The system allows obtaining a high thermal performance.

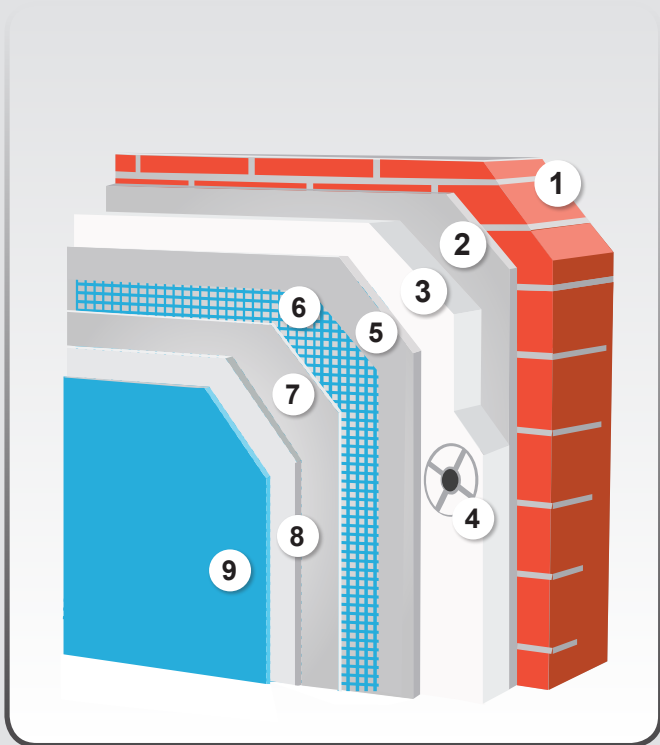

ADVANTAGES:

- Efficient thermal insulation,
- Saving of energy,
- It maintains the external walls at a constant temperature for an optimal internal comfort,
- Protection of buildings over time,
- Benefit/ Conservation of the living space,
- Walls protection,
- Elimination of thermal bridge,
- The installation can also be done in case of bad weather (ECAP SYSTEM),
- Valid for state funding,
- It meets insulating performances required by the related norms.

- 1 Support
- 2 Gluing and base layer
- 3 Thermal insulating board
- 4 Anchors
- 5 Smoothing mortar (layer in which the fiber glass mesh is placed)
- 6 Fiber glass mesh
- 7 Smoothing mortar (layer in which the fiber glass mesh lays)
- 8 Fixative
- 9 Colored finishing

SUPPORT

The system EDIL-Therm[®] can be applied to new or restored supports.

GLUING AND SMOOTHING

Ecap[®] ADP Adhesive Powder

Gluing and ready to use powdered fiber levelling.



INSULATING BOARD

EDIL-Therm[®] L $\lambda=0,035$ W/mK

Dimensions: 1200 x 600 mm - Thickness: from 30 to 200 mm.

EDIL-Therm[®] GT $\lambda=0,031$ W/mK

Dimensions: 1200 x 600 mm - Thickness: from 30 to 200 mm.

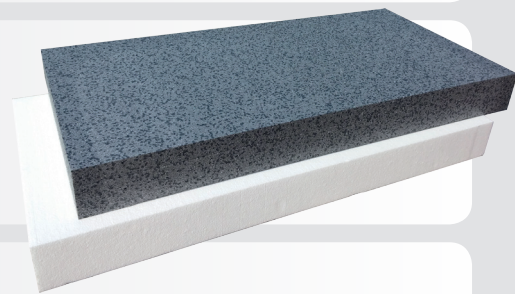

SCAFFOLD

Fiber glass mesh, 4x4 mm, certificated CSTB.

FIXATIVE

Ecap[®] F Fixative

Ecap[®] FF Fiber fixative

COLOURED FINISHING

Ecap[®] FM Finishing Mortar

Ecap[®] AC Acrylic Colour

Ecap[®] STC Silicate Colour

Ecap[®] SC Silicone Colour

Ecap[®] GC Glamish Colour

Ecap[®] SCL Selfcleaning

Ecap[®] AP Acrylic Paint

Ecap[®] STP Silicate Paint

Ecap[®] SP Silicone Paint

Ecap[®] GP Glamish Paint

Ecap[®] EP Elastomeric Paint

Ecap[®] SCLP Selfcleaning Paint



APPLICATIONS:

- New and old buildings,
- Individual houses & apartments,
- Offices and public buildings,
- Industrial and agricultural buildings.

It's also used for the refurbishment and protection of degraded and old façades.



Technical characteristics of EDIL-Therm® system

European technical consent ETAG 004 - ETICS	ETA-13/0390	
Fire reactivity Class EN 13501-1	B-s1, d0	
Thermal Conductivity	EDIL-Therm® L	EDIL-Therm® GT
	$\lambda = 0,035$	$\lambda = 0,031$